

## HOW TO POWER

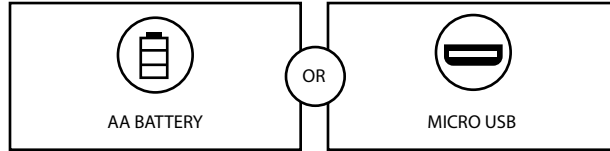

NOTE: USB does not charge cooler & you do not need to use both power sources to operate the iPad cooling system.

## HOW TO TEST BATTERY LIFE

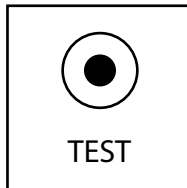

Press the test button located above the word TEST on the side of the iPad cooler. The power light indicator will then blink. That color then indicates the level of battery life.

GREEN: Good Battery Life  
 YELLOW: Low power conditions  
 RED: Battery needs to be replaced

## HOW TO LOAD iPad

1

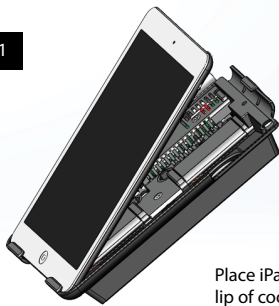

Place iPad under bottom lip of cooling mount.

2



Snap top into top lip and secure iPad.

**IMPORTANT NOTE:**  
 For most effective cooling, place the home button on your iPad on the same side as bottom lip. Correct iPad placement see illustration 2.

## CONVERTING iPad MODELS

The Active Cooling Mount™ will come pre-installed with a bumper out of the box. Depending on the model of iPad, you may configure the ACM according to the size chart.

**WARNING:** Do not force iPad into Actice Cooling Mount, this may result in damage to your iPad. Remove bumpers when using iPad Mini 1 - 3

### Installing/Removing Bumper

Poke rubber bumper out with a pen to remove and squeeze rubber bumper back in with a little force to install.

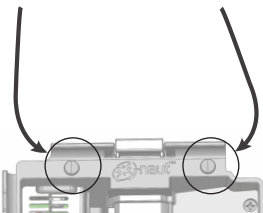

### Installing/Removing Spacer

Peel the backing off the included stick-on spacers, and stick them beneath the iPad holder feet.

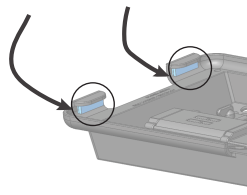

Model	Bumper	Spacer
iPad Pro 11		
iPad Pro 10.5		
iPad Pro 9.7	✗	
iPad Air		
iPad Air 2	✗	
iPad Mini 1 - 3		✗
iPad Mini 4	✗	